

LOWER FLOOR
1309 SQ. FT.
 7' 6" CEILING HEIGHT

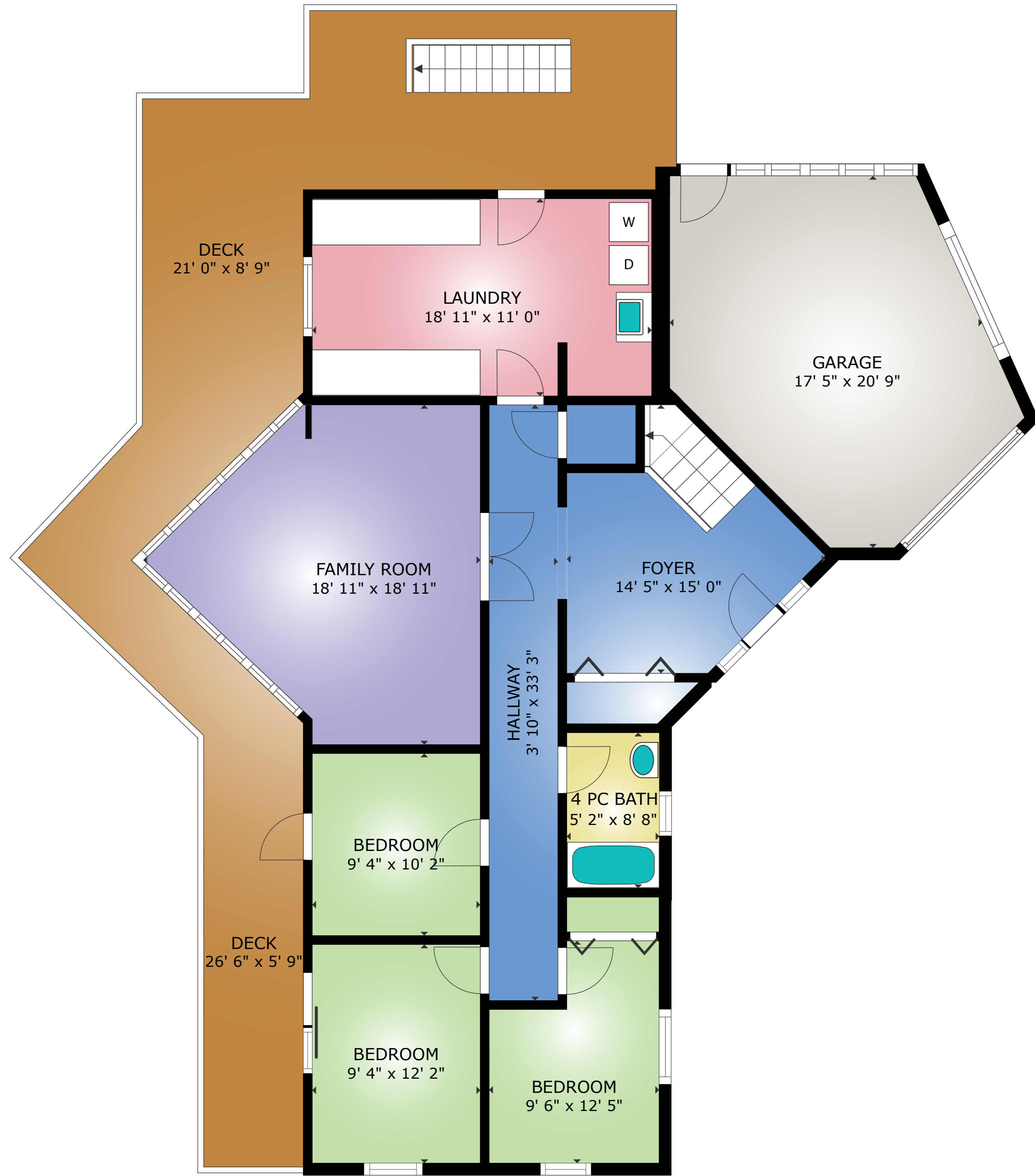

MAIN FLOOR
1454 SQ. FT.
 CEILING HEIGHT VARIES



LOFT
450 SQ. FT.
 CEILING HEIGHT VARIES

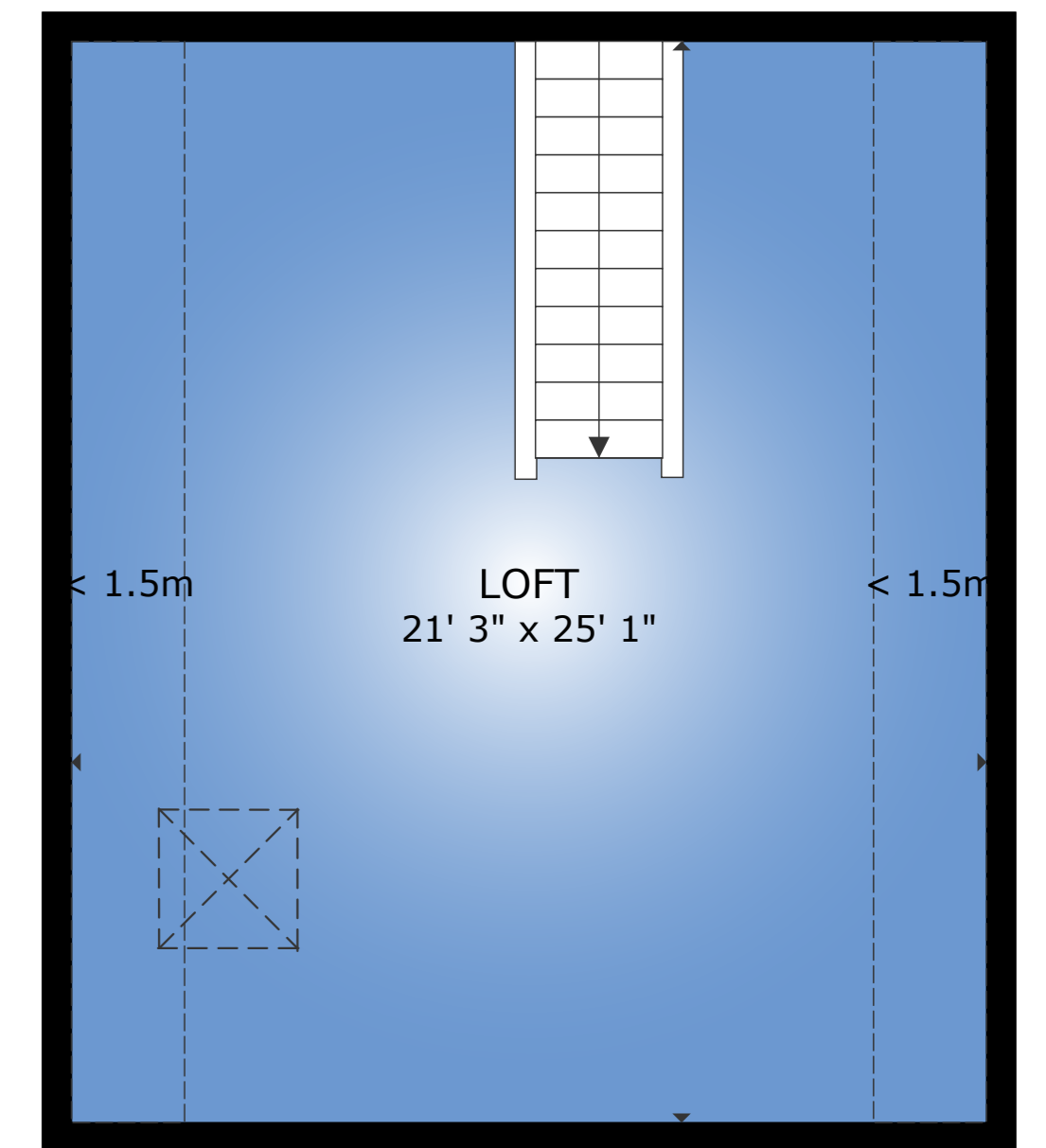

241 SKY VALLEY RD
 AUGUST 28, 2024
 PREPARED FOR THE EXCLUSIVE USE OF SANDRA SMITH.
 SIZES AND DIMENSION ARE APPROXIMATE, ACTUAL MAY VARY.

FLOOR	TOTAL	AREA (SQ. FT.)		
		FINISHED	GARAGE	PATIO/DECK
MAIN	1454	1454		1003
LOFT	450	450		
LOWER	1309	1309	304	611
TOTAL	3213	3213	304	1614

