



Seaside on Morningside

\$349,000 each lot



Loads of sunshine on these neighbouring south-facing waterfront building lots in the heart of Fulford Village. Gorgeous shoreline and level building area. Zoning for both lots is Industrial 4(a), which allows for residential use if the primary use is marine dependent.

Sandra Smith

personal real estate corporation

250.537.1201

Toll Free: 1.800.537.1201

www.saltspringhomefinder.com

saltspringhomefinder@gmail.com



ADDRESS: LOT 1 & LOT A Morningside MLS#: 382304, 382308 PID: 025-639-749, 025-639-269
 LEGAL: Lot 1, DL 2018, Plan VIP75141, & Lot A, Plan VIP75140 LD 16
 PRICE: \$349,000 ea. lot LISTED BY: Sandra Smith, PREC
 TAXES 2017: \$2,603 PHONE: 250.537.1201 S. COMM: 3% & 1.5%

LOT SIZE: 0.15 acres (each lot)
 WASTE: septic to be developed

WATER: Community

ZONING: Industrial 4(a)

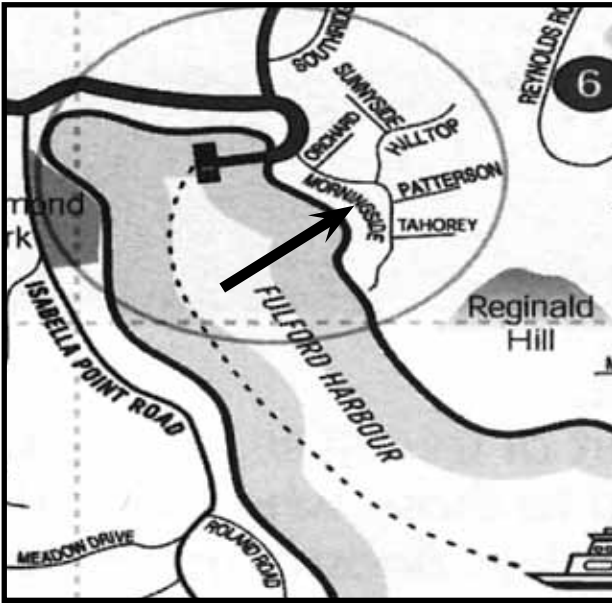

AREA MAP

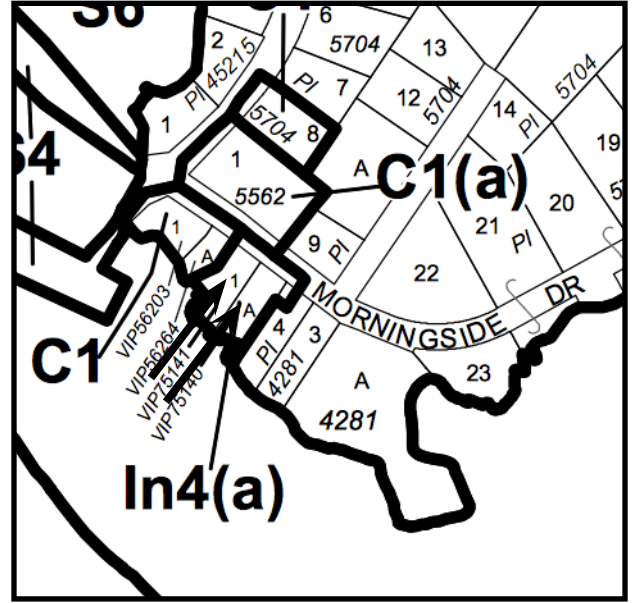

ZONING

AERIAL VIEW



**The above information is from sources believed to be reliable but should not be relied upon without verification. MACDONALD REALTY Salt Spring Island assumes no responsibility for accuracy.*



Sandra Smith

www.saltsspringhomefinder.com